

PRODUCT SPECIFICATIONS

For current product specifications, please go to www.griffin-stands.com and type the model number into the search bar. Locate the product listing to view the current factory specifications.

TROUBLE SHOOTING

Performance Issue, Uneven or Unstable- Make sure all nuts and bolts are tight on the product. If they are, then loosen all nuts and bolts 1 full turn counter-clockwise, then go back and tighten each bolt only ½ turn tight. Then do a final tighten turn for another ½ turn tight. Next, Make sure there are not any missing nuts or bolts. Third, ensure all parts on the product are not broken or defective. Finally, Re-read the assembly instructions or watch the product demonstration video to ensure you have correctly assembled or are using the product properly with factory specifications.

Missing Parts- The pictures, videos and images shown in this manual might have changed style or count due to the product being redesigned. So in rare cases the part may no longer be included or of a different style. However, if you think you are missing a part that is necessary to the assembly and use of your product, then first carefully double check all packaging for any parts you think are missing. Some parts might be hiding in the packaging or loose in an inner box.

COMPANY INFORMATION AND SUPPORT

THANK YOU FOR YOUR PURCHASE

Thank you for purchasing the Griffin Telescoping Microphone Stand. Your product comes with a 1 year factory warranty from purchase date. Please read all assembly instructions prior to assembling your new cart. Pictures that may aid in assembly can be found by going to www.griffin-stands.com and typing AP3614 / AP3607 into the search bar.

Griffin™ stands and accessories are manufactured in several innovative factories responsible for developing products that address the newest needs and trends of the current market. We take pride in the Griffin™ brand and endeavor to be on the forefront of the musical stands and musical and lighting accessories market.



Griffin | 11408 Hwy 64 W, Tyler, TX 75704 |
info@griffin-stands.com | www.Griffin-Stands.com



User Manual Model# AP3614 / AP3607



Telescoping Microphone Stand

ASSEMBLY INSTRUCTIONS

Step 1 – Loosen the knob at the base by turning it clockwise as shown on **Figure 1**. Expand and spread the legs and tighten the knob to hold the legs in place.

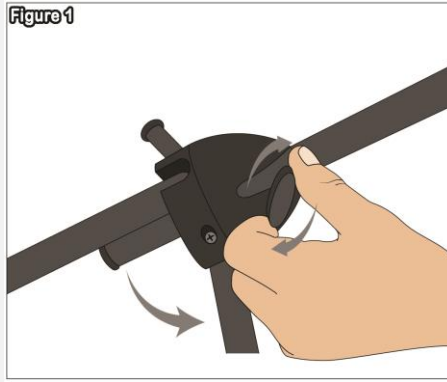

Step 2 – Take the boom arm, insert it in the top shaft of the stand and screw it fully (see **Figure 2**).

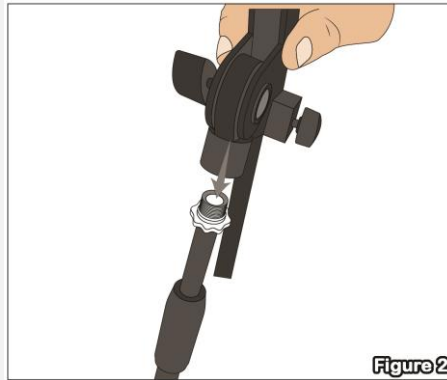

Step 3 – To adjust the height of the stand, simply loosen the hand knob near the connection of the boom piece then adjust up or down the inner pipe to your preference and tighten to hold in place (see **Figure 3**).

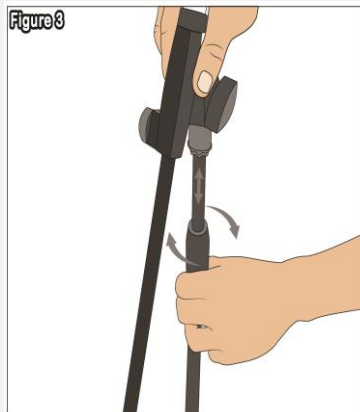

Step 4 – Loosen the knob shown in **Figure 4** to adjust the angle of the boom pipe.

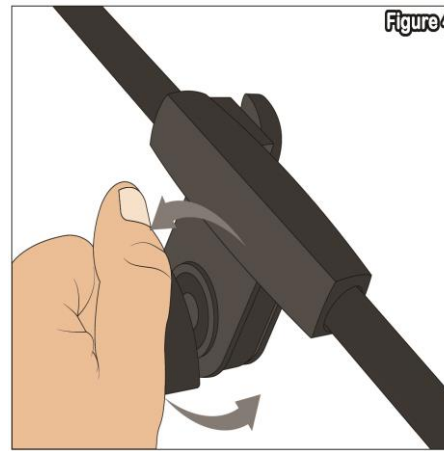

Step 5 - To adjust the boom, loosen the knob located on the left side of the boom and pull or push the boom forward or backward, then tighten the knob to hold in place as shown in **Figure 5**. This Microphone Stand has an additional telescoping boom located near the microphone. To extend or retract, loosen the knob directly behind the microphone clip and extend or retract the boom (See **Figure 6**). Tighten the knob to hold it in place.

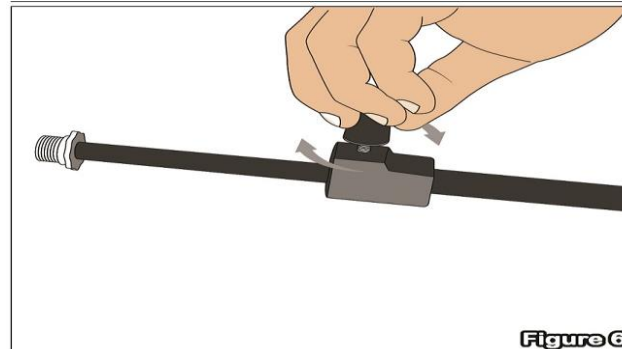
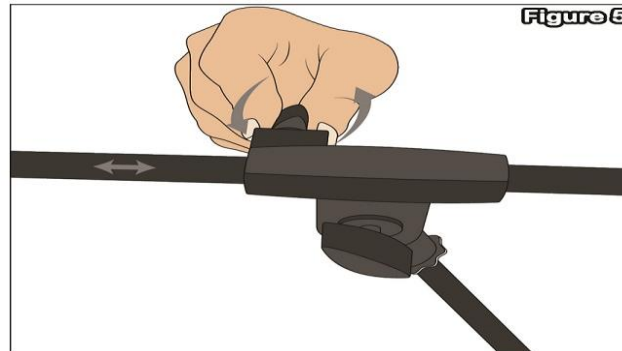

Step 6 – **Figure 7** shows how to screw in the microphone clip. Use a microphone clip or shock mount to mount your microphone.

Figure 7

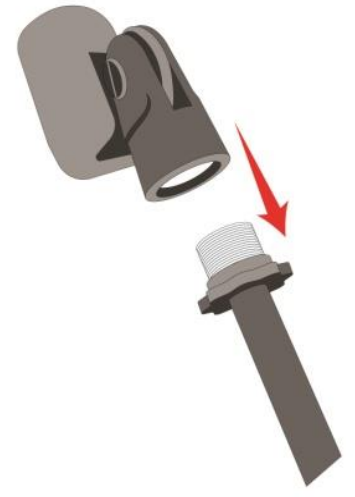

Step 7 – For safety reasons, please always make sure to test the stability and safety of the product before use. Double check all nuts and bolts, knobs and connectors, make sure that these are tight and securely fastened before use of your product. Test the product under light use or light loads the first time to confirm assembly and structure of the product is correct.

ASSEMBLY AND DEMONSTRATION VIDEO

Please scan the QR Code below for the product demonstration video. Or go to the URL shown here and find the product video. www.Griffin-Stands.com/Videos



Scan me