

Company information and Support

Thank you for your Purchase

Thank you for purchasing the Fat Toad DJ Booth Stand (Model XPF8017). Your product comes with a 1-year factory warranty from purchase date. Please read all assembly instructions prior to assembling your new stand. Pictures that may aid in assembly can be found by going to www.Fattoadpro.com and typing XX-8500 into the search bar.

Fat Toad™ stands and accessories are manufactured in several innovative factories responsible for developing products that address the newest needs and trends of the current market. We take pride in the Fat Toad™ brand and endeavor to be on the forefront of the musical stands and musical and lighting accessories market.



Fat Toad | 11408 Hwy 64 W, Tyler, TX 75704 |
info@fattoadpro.com | www.FattoadPro.com



User Manual Model# XX-8500



Sliding Keyboard Stand with Boom Mic

Product Specifications

For current product specifications, please go to www.FattoadPro.com and type the model number into the search bar. Locate the product listing to view the current factory specifications.

Trouble Shooting

Performance Issue, Uneven or Unstable- Make sure all nuts and bolts are tight on the product. If they are, then loosen all nuts and bolts 1 full turn counter-clockwise, then go back and tighten each bolt only ½ turn tight. Then do a final tighten turn for another ½ turn tight. Next, Make sure there are not any missing nuts or bolts. Third, ensure all parts on the product are not broken or defective. Finally, Re-read the assembly instructions or watch the product demonstration video to ensure you have correctly assembled or are using the product properly with factory specifications.

Missing Parts- The pictures, videos and images shown in this manual might have changed style or count due to the product being redesigned. So in rare cases the part may no longer be included or of a different style. However, if you think you are missing a part that is necessary to the assembly and use of your product, then first carefully double check all packaging for any parts you think are missing. Some parts might be hiding in the packaging or loose in an inner box.

Assembly Instructions

Step 1 – Slide the 3 legs out from the bottom of the base. If the legs feel stuck or won't slide out, press the small chrome locking pin to release the lock. (Figure 1)

Step 2 – Unfold both arms on the top tier (Figure 2) and slide the arm mounting hub up to your desired position, then turn the knob tight on the arm hub to lock the arm hub (Figure 3).

Do the same with the second lower mount. To adjust the height and distance between the two mounts, simply loosen the knob. These mounts are fully adjustable depending on

your preference. If one of the arms, does not seem to be level with the other side, then use one of the included padded spacers with adhesive backing and insert that foam padded spacer under the arm rest (Figure 4).



Figure 1



Figure 2



Figure 3

Step 3 - Lower the bottom tilt blocker to the ground by loosening the small wing knob. This prevents the stand from tilting forward when hard pressure is applied to the keyboards. (Figure 5).

Step 4 – Take the microphone boom adapter and screw on to the top of the red main post. Make sure to attach it vertically at the screw post and not at an angle. This will make it easier to be tightened. (See Figure 6) While screwing it, hold the chrome adapter of the screw post on the red main post and counter the spin of the boom adapter.

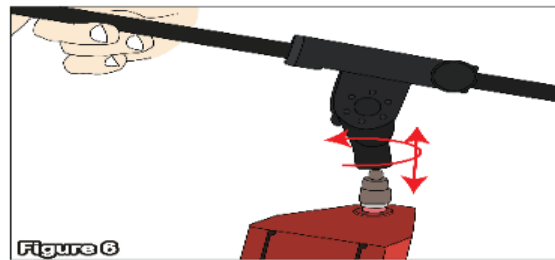

Figure 6

Step 5 – To adjust the angle of the boom microphone arm, loosen the knob as shown in Figure 7. To adjust the length of the arm, loosen the knob just below the arm as shown in Figure 8. Tighten these knobs to secure the angle and length you prefer.



Figure 4

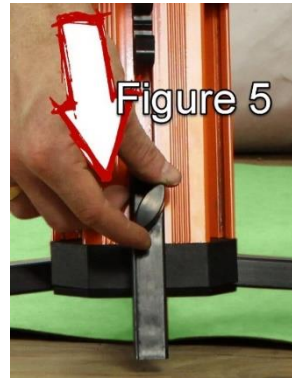

Figure 5

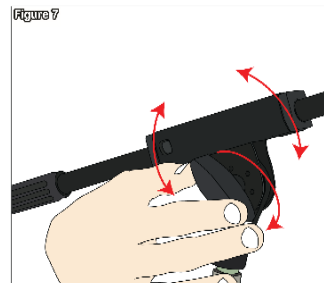

Figure 7

Step 6 – As shown in Figure 9, you can now place your equipment on the mounts. These mounts have lips that will secure your equipment from falling and rubber resting pads to keep your equipment from being scratched against the metal mount.

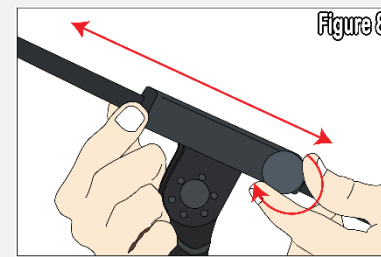

Figure 8

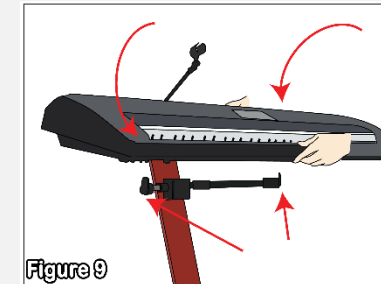

Figure 9

Step 7 – For safety reasons, please always make sure to test the stability and safety of the product before use. Double check all nuts and bolts, knobs and connectors, make sure that these are tight and securely fastened before use of your product. Test the product under light use or light loads the first time to confirm assembly and structure of the product is correct.

Assembly and Demonstration Video

Please scan the QR Code below for the product demonstration video, or go to the URL shown here and find the product video. www.FattoadPro.com/Videos



Scan me