

PRODUCT SPECIFICATIONS

For current product specifications, please go to www.griffin-stands.com and type the model number into the search bar. Locate the product listing to view the current factory specifications.

TROUBLE SHOOTING

Performance Issue, Uneven or Unstable- Make sure all nuts and bolts are tight on the product. If they are, then loosen all nuts and bolts 1 full turn counter-clockwise, then go back and tighten each bolt only ½ turn tight. Then do a final tighten turn for another ½ turn tight. Next, Make sure there are not any missing nuts or bolts. Third, ensure all parts on the product are not broken or defective. Finally, Re-read the assembly instructions or watch the product demonstration video to ensure you have correctly assembled or are using the product properly with factory specifications.

Missing Parts- The pictures, videos and images shown in this manual might have changed style or count due to the product being redesigned. So in rare cases the part may no longer be included or of a different style. However, if you think you are missing a part that is necessary to the assembly and use of your product, then first carefully double check all packaging for any parts you think are missing. Some parts might be hiding in the packaging or loose in an inner box.

COMPANY INFORMATION AND SUPPORT

THANK YOU FOR YOUR PURCHASE

Thank you for purchasing the Griffin Sliding Keyboard Stand with Boom Mic. Your product comes with a 1 year factory warranty from purchase date. Please read all assembly instructions prior to assembling your new cart. Pictures that may aid in assembly can be found by going to www.griffin-stands.com and typing XX-388W into the search bar.

Griffin™ stands and accessories are manufactured in several innovative factories responsible for developing products that address the newest needs and trends of the current market. We take pride in the Griffin™ brand and endeavor to be on the forefront of the musical stands and musical and lighting accessories market.



Griffin | 11408 Hwy 64 W, Tyler, TX 75704 |
info@griffin-stands.com | www.Griffin-Stands.com



User Manual Model# XX-388W



Sliding Keyboard Stand with Boom Mic

ASSEMBLY INSTRUCTIONS

Step 1 – Take the **Parts K** (back leg), **P** (long horizontal leg) and **H** (red main post). Place **Part K** at the bottom of the red main post by using **Part A** (T-Plate) to secure the legs to the main post.

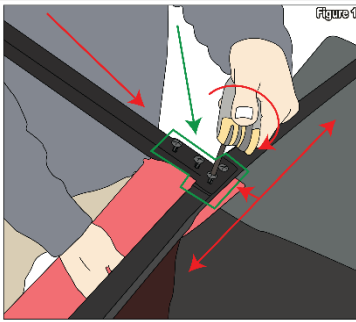

Align the bolt slots to the ones on the red main post, use bolts labeled **Part C**. Insert all 4 bolts into the holes first through the **Part A** (T-Plate), then into the legs (**Part P** and **K**) and finally in to the main column shaft (**Part H**). Important. Do not screw in fully any bolt until all 4 bolts are fully inserted. Then take the front Legs (**Part P**) and insert it under T-plate just below the **Part K** and screw in. Tightly screw the bolts one turn at a time for each bolt to make sure that no bolt is adding too much tension on one side, this will also make sure that the stand will be leveled. Please see **Figure 1**.

Step 2 – Now, assemble the keyboard holders. Take the **Part J** (joint arms connector) and **Part Q** (support arms), then check the internal plastic sleeves where **Part Q**

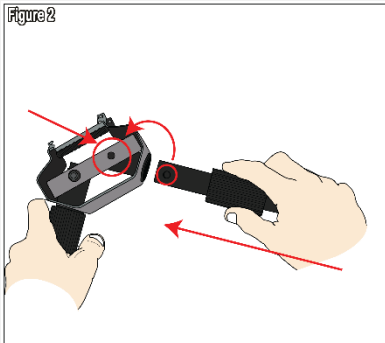

(mounting arms) will be inserted. Check the sleeves to make sure that the holes are all lined up to the outer holes of **Part J**. You might need to adjust the sleeves inside **Part J** (joint), so that they will line up. Once done, insert **Part Q** (mounting arms) and line up the holes as shown in **Figure 2**.

Step 3 – Turn the part assembled above and screw in by using **Part B** (bolts) and adding **Part D** (washers). (See **Figure 3**) Repeat step 2 and 3 for the other keyboard mount.

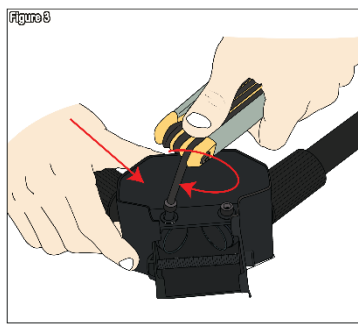

Step 4 – Take the keyboard mount assembled from the step above and slide in to the track of the main red post from the bottom going up. (See **Figure 4**) Once you are satisfied with the position of the mount insert the knob with threaded bolt into the mounting arm hub, tighten it to secure the

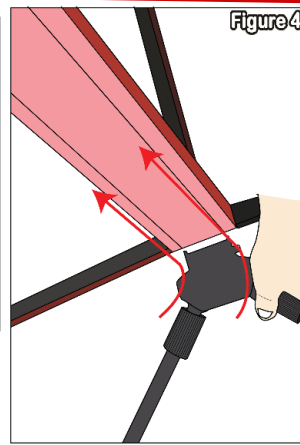

mount's location as shown in **Figure 5**. Do the same thing with the second mount. To adjust the height and distance between the two mounts, simply loosen the knob. These mounts are fully adjustable depending on your preference.

Step 5 – Take **Part L** which is the microphone boom adapter and screw on to the top of the red main post. Make sure to screw it on vertically at the screw post and not on an angle. This will make it easier to be screwed on. (See **Figure 6**) While screwing it on, hold the chrome adapter of the screw post on the red main post and counter the spin of the boom adapter.

Step 6 – To adjust the angle of the boom microphone arm, loosen the knob as shown in **Figure 7**. To adjust the length of the arm, loosen the knob just below the arm as shown in **Figure 8**. Tighten these knobs to secure the angle and length you preferred.

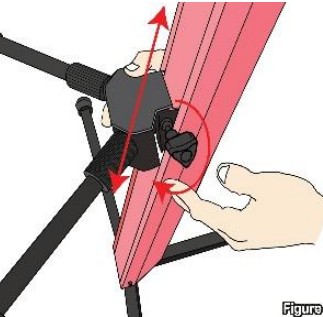

Figure 5

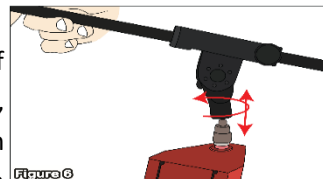
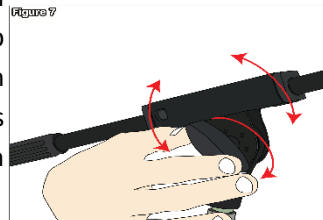

Figure 6



Step 7 – As shown in **Figure 9**, you can now place your equipment on the mounts. These mounts have lips that will secure your equipment from falling and rubber resting pads to keep your equipment from being scratched against the metal mount.

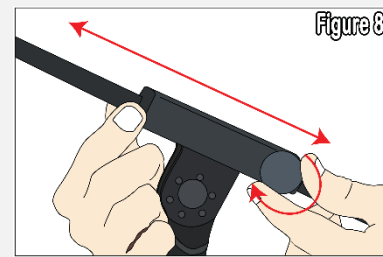

Figure 8

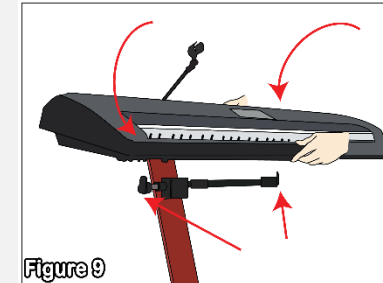

Figure 9

Step 8 – For safety reasons, please always make sure to test the stability and safety of the product before use. Double check all nuts and bolts, knobs and connectors, make sure that these are tight and securely fastened before use of your product. Test the product under light use or light loads the first time to confirm assembly and structure of the product is correct.

ASSEMBLY AND DEMONSTRATION VIDEO

Please scan the QR Code below for the product demonstration video. Or go to the URL shown here and find the product video. www.Griffin-Stands.com/Videos



Scan me