

PRODUCT SPECIFICATIONS

For current product specifications, please to go www.griffin-stands.com and type the model number into the search bar. Locate the product listing to view the current factory specifications.

TROUBLE SHOOTING

Performance Issue, Uneven or Unstable- Make sure all nuts and bolts are tight on the product. If they are, then loosen all nuts and bolts 1 full turn counter-clockwise, then go back and tighten each bolt only ½ turn tight. Then do a final tighten turn for another ½ turn tight. Next, Make sure there are not any missing nuts or bolts. Third, ensure all parts on the product are not broken or defective. Finally, Re-read the assembly instructions or watch the product demonstration video to ensure you have correctly assembled or are using the product properly with factory specifications.

Missing Parts- The pictures, videos and images shown in this manual might have changed style or count due to the product being redesigned. So in rare cases the part may no longer be included or of a different style. However, if you think you are missing a part that is necessary to the assembly and use of your product, then first carefully double check all packaging for any parts you think are missing. Some parts might be hiding in the packaging or loose in an inner box.

COMPANY INFORMATION AND SUPPORT

THANK YOU FOR YOUR PURCHASE

Thank you for purchasing the Griffin Rack Mount Rolling Stand. Your product comes with a 1 year factory warranty from purchase date. Please read all assembly instructions prior to assembling your new cart. Pictures that may aid in assembly can be found by going to www.griffin-stands.com and typing XR-411 into the search bar.

Griffin™ stands and accessories are manufactured in several innovative factories responsible for developing products that address the newest needs and trends of the current market. We take pride in the Griffin™ brand and endeavor to be on the forefront of the musical stands and musical and lighting accessories market.



Griffin | 11408 Hwy 64 W, Tyler, TX 75704 |
info@griffin-stands.com | www.Griffin-Stands.com



Griffin™ User Manual

Model# XR-411

Rack Mount Stand



Why did we put a tire on front of the manual?

To make you read this → This stand must be installed properly. Which means, you must only hand tighten all bolts/nuts 1st and must be in a star pattern order just like if you were to change a tire. 2nd -Then in star patten use a wrench to tighten bolts to 80%. 3rd-Finally, In star pattern tighten all bolts to 100%.

If you do not follow the proper tightening procedure above, your stand will be wobbly or uneven. If you return stand claiming it is "wobbly" or "unstable" then we will reassemble it to confirm "user error." Don't be a "user error" 😊

ASSEMBLY INSTRUCTIONS

Step 1 – Take the bottom floor cross supports and screw in the caster wheels provided as shown in **FIGURE 1**. Do the same for both sides and front and back.

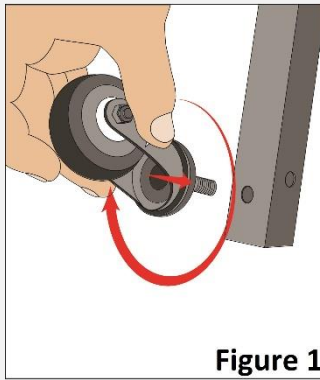

Step 2 – Take 2 of the horizontal support bars and connect to both of the floor cross supports. These have locking clamps that fit through the holes of the bottom support bar and fix in place with a bolt as shown in **FIGURE 2**.

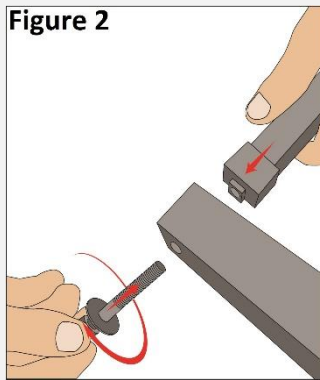

Step 3 – Attach the upright supports to the base as shown in **FIGURE 3**. **DO NOT FULLY TIGHTEN UNTIL YOU HAVE COMPLETED STEP 4.**

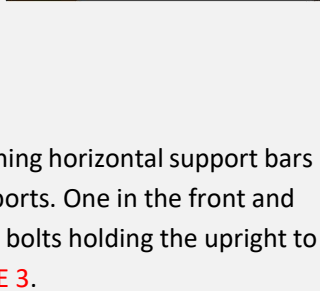

Step 4 – Attach the 2 remaining horizontal support bars in between the upright supports. One in the front and one in the back. Tighten the bolts holding the upright to the base as shown in **FIGURE 3**.

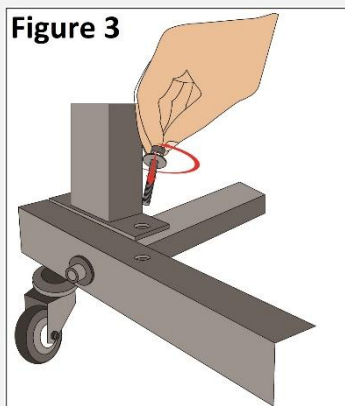

Step 5 - Slide the microphone boom arm into the round holder located on the left side of the stand. Tighten the knob to lock into place. See **FIGURE 4**. The height of the boom arm can be adjusted like any standard microphone stand as shown in **FIGURE 5**. The tilt of the boom can be adjusted using the knob shown in **FIGURE 6**. The forward and backward motion of the boom arm can be adjusted by using the knob in **FIGURE 7**.

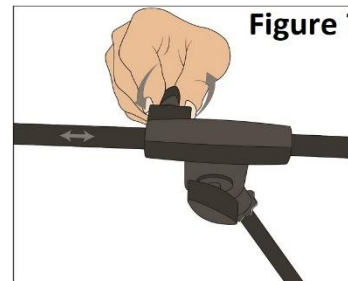
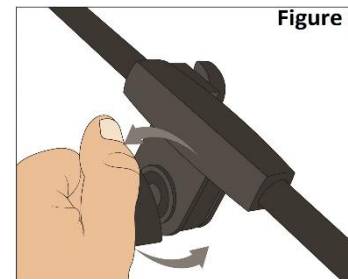
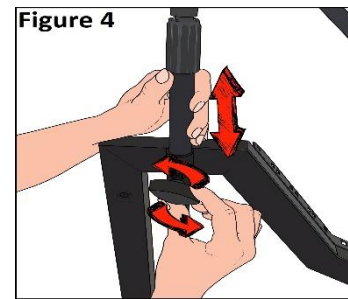

Step 6 – Determine which slots you want your gear in and attach the supplied 20 cage nuts as shown in **FIGURE 8**. (For more information on how these work, go to YouTube and search “cage nut use.”)

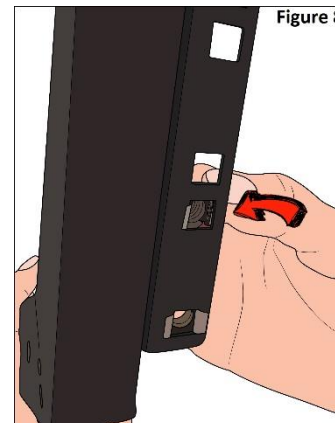

Step 7 – For safety reasons, please always make sure to test the stability and safety of the product before use. Double check all nuts and bolts, knobs and connectors, make sure that these are tight and securely fastened before use of your product. Test the product under light use or light loads the first time to confirm assembly and structure of the product is correct.



ASSEMBLY AND DEMONSTRATION VIDEO

Please scan the QR Code below for the product demonstration video. Or go to the URL shown here and find the product video. www.Griffin-Stands.com/Videos

