

PRODUCT SPECIFICATIONS

For current product specifications, please to go www.FattoadPro.com and type the model number into the search bar. Locate the product listing to view the current factory specifications.

TROUBLE SHOOTING

Performance Issue, Uneven or Unstable- Make sure all nuts and bolts are tight on the product. If they are, then loosen all nuts and bolts 1 full turn counter-clockwise, then go back and tighten each bolt only ½ turn tight. Then do a final tighten turn for another ½ turn tight. Next, Make sure there are not any missing nuts or bolts. Third, ensure all parts on the product are not broken or defective. Finally, Re-read the assembly instructions or watch the product demonstration video to ensure you have correctly assembled or are using the product properly with factory specifications.

Missing Parts- The pictures, videos and images shown in this manual might have changed style or count due to the product being redesigned. So in rare cases the part may no longer be included or of a different style. However, if you think you are missing a part that is necessary to the assembly and use of your product, then first carefully double check all packaging for any parts you think are missing. Some parts might be hiding in the packaging or loose in an inner box.

COMPANY INFORMATION AND SUPPORT

THANK YOU FOR YOUR PURCHASE

Thank you for purchasing the Fat Toad DJ Workstation Stand. Your product comes with a 1-year factory warranty from purchase date. Please read all assembly instructions prior to assembling your new stand. Pictures that may aid in assembly can be found by going to www.Fattoadpro.com and typing LS-913 into the search bar.

Fat Toad™ stands and accessories are manufactured in several innovative factories responsible for developing products that address the newest needs and trends of the current market. We take pride in the Fat Toad™ brand and endeavor to be on the forefront of the musical stands and musical and lighting accessories market.



User Manual Model# LS-913



DJ Workstation Stand

ASSEMBLY INSTRUCTIONS

Step 1 - Take the tripod stand and open the legs wide, push it down as this will be the base of the stand. Make sure to tighten the knob where the tripod legs meet on the stand. (See **FIGURE 1**). It's very important that the legs must be spread all the way out and down for maximum stability. Spread the legs fully down so that the hub base meets/stops at the 2 bolts at the bottom of the column.

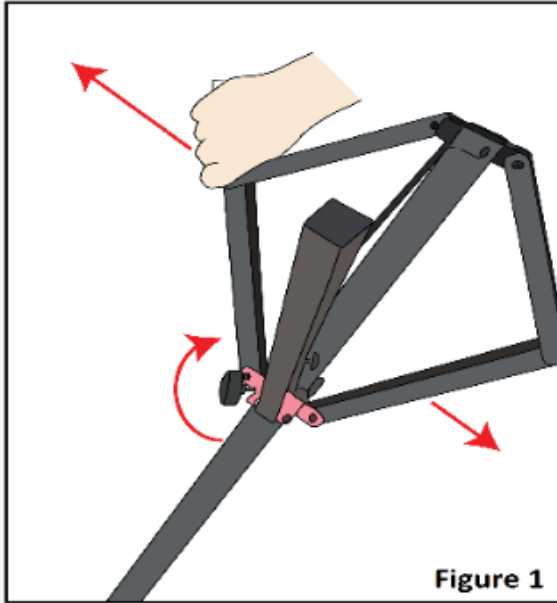

Step 2 - Lower the arms already attached to the stand and slide the red arm mounting bracket onto the stand. Tighten the knob to hold it in place. (See **FIGURE 2**).

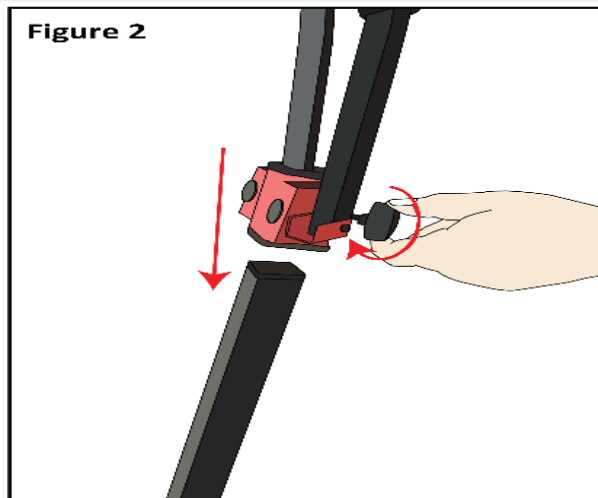

Step 3 - Attach the arms to the bracket using a Philips head screwdriver as seen in **FIGURE 3**.

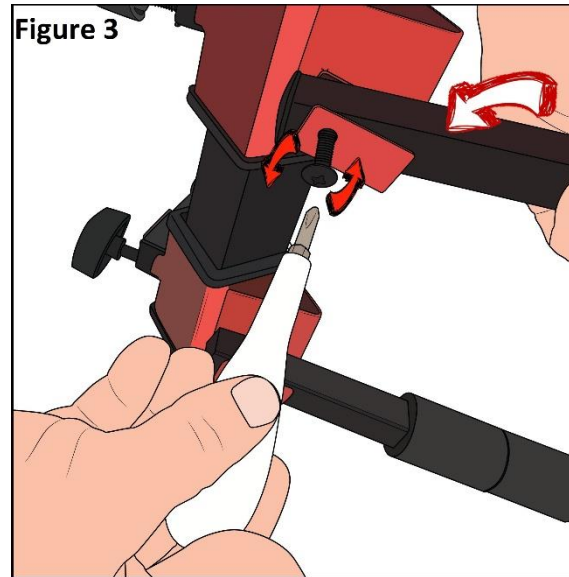

Step 4 - Push down the support folding arms (folding mounting arms) as seen on **FIGURE 4**.

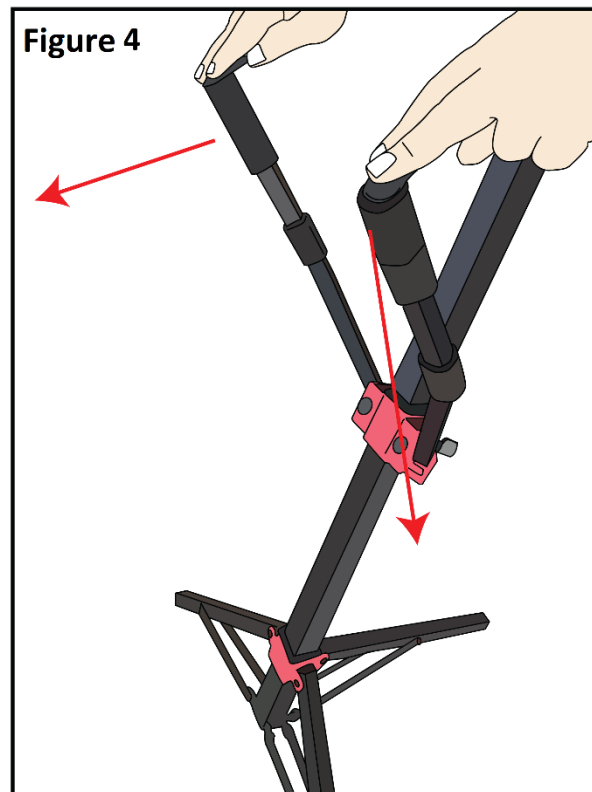

Step 5 - Depending on how much weight is placed on this stand you may need to add a counterbalance such as some cables or a dumbbell as seen in **FIGURE 5**.

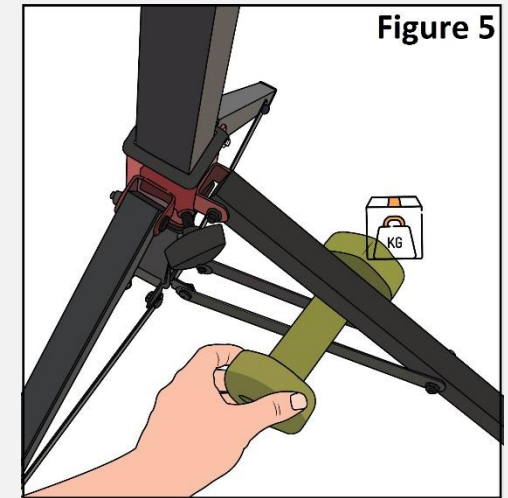

Step 6 - For safety reasons, please always make sure to test the stability and safety of the product before use. Double check all nuts and bolts, knobs and connectors, make sure that these are tight and securely fastened before use of your product. Test the product under light use confirming assembly and structure of the product is correct.

ASSEMBLY AND DEMONSTRATION VIDEO

Please scan the QR Code below for the product demonstration video. Or go to the URL shown here and find the product video. www.FatToadPro.com/Videos



Scan me