

PRODUCT SPECIFICATIONS

For current product specifications, please to go www.FattoadPro.com and type the model number into the search bar. Locate the product listing to view the current factory specifications.

TROUBLE SHOOTING

Performance Issue, Uneven or Unstable- Make sure all nuts and bolts are tight on the product. If they are, then loosen all nuts and bolts 1 full turn counter-clockwise, then go back and tighten each bolt only ½ turn tight. Then do a final tighten turn for another ½ turn tight. Next, Make sure there are not any missing nuts or bolts. Third, ensure all parts on the product are not broken or defective. Finally, Re-read the assembly instructions or watch the product demonstration video to ensure you have correctly assembled or are using the product properly with factory specifications.

Missing Parts- The pictures, videos and images shown in this manual might have changed style or count due to the product being redesigned. So in rare cases the part may no longer be included or of a different style. However, if you think you are missing a part that is necessary to the assembly and use of your product, then first carefully double check all packaging for any parts you think are missing. Some parts might be hiding in the packaging or loose in an inner box.

COMPANY INFORMATION AND SUPPORT

THANK YOU FOR YOUR PURCHASE

Thank you for purchasing the Fat Toad DJ Laptop Computer Stand. Your product comes with a 1-year factory warranty from purchase date. Please read all assembly instructions prior to assembling your new stand. Pictures that may aid in assembly can be found by going to www.Fattoadpro.com and typing LS01 into the search bar.

Fat Toad™ stands and accessories are manufactured in several innovative factories responsible for developing products that address the newest needs and trends of the current market. We take pride in the Fat Toad™ brand and endeavor to be on the forefront of the musical stands and musical and lighting accessories market.



Fat Toad | 11408 Hwy 64 W, Tyler, TX 75704 |
info@fattoadpro.com | www.FattoadPro.com



User Manual Model# LS01



DJ Laptop Computer Stand

ASSEMBLY INSTRUCTIONS

PART NO.	PART NAME	QTY
1	Table or case clamp	2
2	Right bottom support	1
3	Plastic knob	4
4	Rubber wash	8
5	Right top holder	1
6	EVA Pad	4
7	Cross rod	2
8	Width adding piece	2
9	Left top holder	1
10	Left bottom support	1
11	M6 Screw	4
12	Level table bar	2
13	M5 Screw	4

Step 1 – Attach the stick on pads (Part No. 6) to parts 5, 9 and 12. Use two sticks on pads per part. One in the front and one in the back.

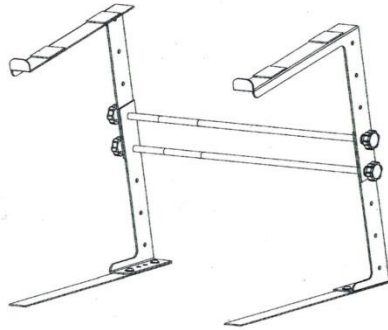

FOR TABLE TOP

- Attach part 2 to part to part 12 as shown in the diagram using the four of the smaller screws (M5 screws). NOTE: The base has four holes. Only two holes are threaded. Repeat using parts 10 and 12 for the other side.
- There are six round cross supports included. The two long ones (part 7) are the main cross supports. The stand can be widened by attaching either one or two of the shorter rods (part 8) to each of the main cross supports. Line up the holes of the left top holder (Part 9) with the holes of the left bottom support (part 10) to the desired height and insert the rods through the holes. Place a washer (part 4) on the end and secure with the plastic knobs (part 3). Repeat for the right side using parts 5 and 2.

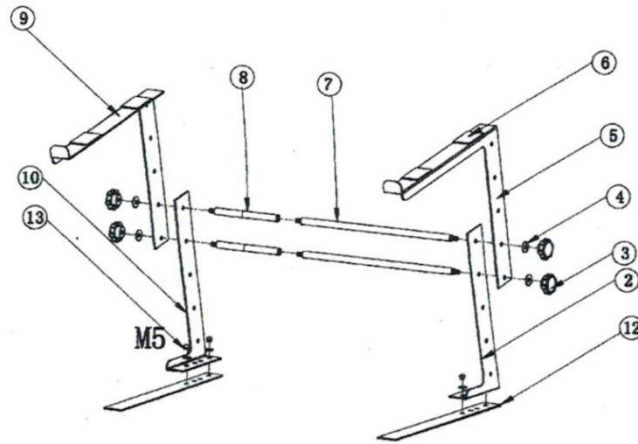

Place on a table

TO CLAMP TO A TABLE

- Attach part 2 to part 1 using the larger M6 screws (part 11) with the knobs pointed down. Repeat using parts 1 and 10 for the other side.
- Repeat step two from the table top instructions.

Clamp on a table

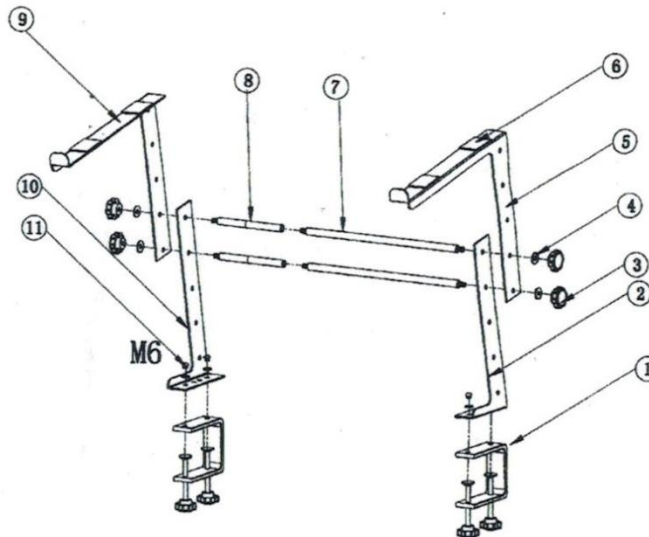

TO CLAMP TO A STAND

- Attach part 2 to part 1 using the larger M6 screws (Part 11) with the knobs pointed toward the rear of the stand. Repeat using parts 1 and 10 for the other side.
- Repeat step 2 from the table top instructions

Clamp on a case

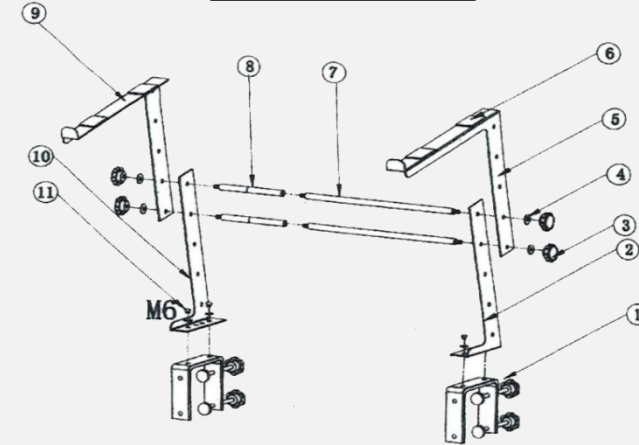

Step 3 – For safety reasons, please always make sure to test the stability and safety of the product before use. Double check all nuts and bolts, knobs and connectors, make sure that these are tight and securely fastened before use of your product. Test the product under light use or light loads the first time to confirm assembly and structure of the product is correct.

ASSEMBLY AND DEMONSTRATION VIDEO

Please scan the QR Code below for the product demonstration video. Or go to the URL shown here and find the product video. www.FattoadPro.com/Videos



Scan me