

## PRODUCT SPECIFICATIONS

For current product specifications, please go to [www.griffin-stands.com](http://www.griffin-stands.com) and type the model number into the search bar. Locate the product listing to view the current factory specifications.

## TROUBLE SHOOTING

**Performance Issue, Uneven or Unstable-** Make sure all nuts and bolts are tight on the product. If they are, then loosen all nuts and bolts 1 full turn counter-clockwise, then go back and tighten each bolt only ½ turn tight. Then do a final tighten turn for another ½ turn tight. Next, Make sure there are not any missing nuts or bolts. Third, ensure all parts on the product are not broken or defective. Finally, Re-read the assembly instructions or watch the product demonstration video to ensure you have correctly assembled or are using the product properly with factory specifications.

**Missing Parts-** The pictures, videos and images shown in this manual might have changed style or count due to the product being redesigned. So in rare cases the part may no longer be included or of a different style. However, if you think you are missing a part that is necessary to the assembly and use of your product, then first carefully double check all packaging for any parts you think are missing. Some parts might be hiding in the packaging or loose in an inner box.

## COMPANY INFORMATION AND SUPPORT

### THANK YOU FOR YOUR PURCHASE

Thank you for purchasing the Guitar Amp Tilt Back Floor Stand. Your product comes with a 1 year factory warranty from purchase date. Please read all assembly instructions prior to assembling your new cart. Pictures that may aid in assembly can be found by going to [www.griffin-stands.com](http://www.griffin-stands.com) and typing LK-518B into the search bar.

Griffin™ stands and accessories are manufactured in several innovative factories responsible for developing products that address the newest needs and trends of the current market. We take pride in the Griffin™ brand and endeavor to be on the forefront of the musical stands and musical and lighting accessories market.



Griffin | 11408 Hwy 64 W, Tyler, TX 75704 |  
[info@griffin-stands.com](mailto:info@griffin-stands.com) | [www.Griffin-Stands.com](http://www.Griffin-Stands.com)



## User Manual Model# LK-518B



# Guitar Amp Tilt Back Floor Stand

## ASSEMBLY INSTRUCTIONS

**Step 1** – Loosen knob A and extend back leg to a minimum of 16 inches as seen in **FIGURE 1**.

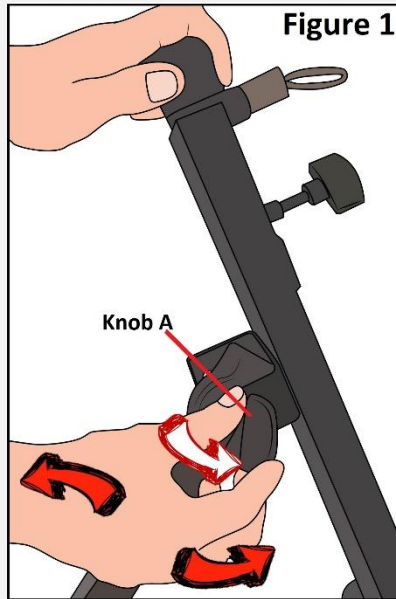

**Step 2** – As seen in **FIGURE 2**, loosen knob B, pull the locking pin C out and insert the height adjustment pole to the highest setting. Reset pin C and tighten knob B. This is the same process used for height adjustment after stand assembly is complete.

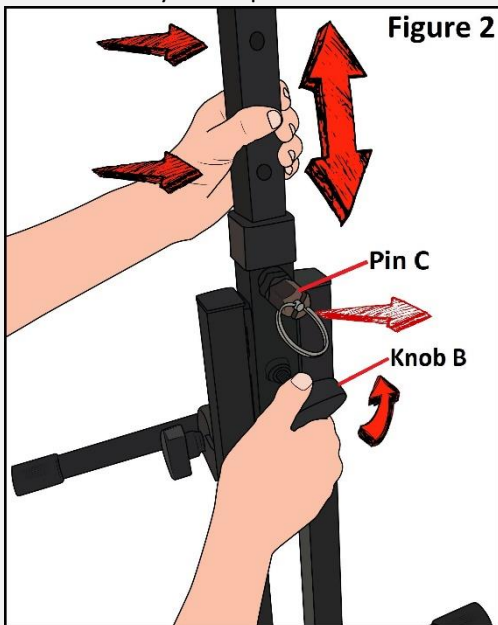

**Step 3** – Attach the side rails using the supplied bolts, washers and nuts as seen in **FIGURE 3**. We have included an Allen wrench. Nuts require a 10mm or an adjustable (Crescent) wrench. The washer goes between the steel frame and the nut. Attach the protective foam pads to the side rails to help prevent scuffs to your equipment.

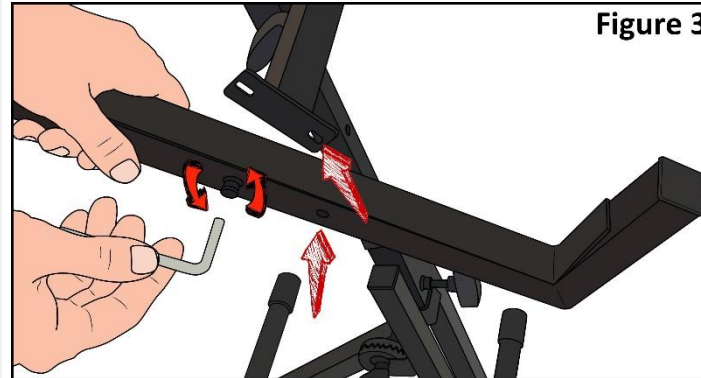

**Step 4** – As seen in **FIGURE 4**, loosen knob D to adjust the pitch of your stand. Line up the teeth to the corresponding slot, then retighten knob D when you are satisfied with the adjustment of your stand.

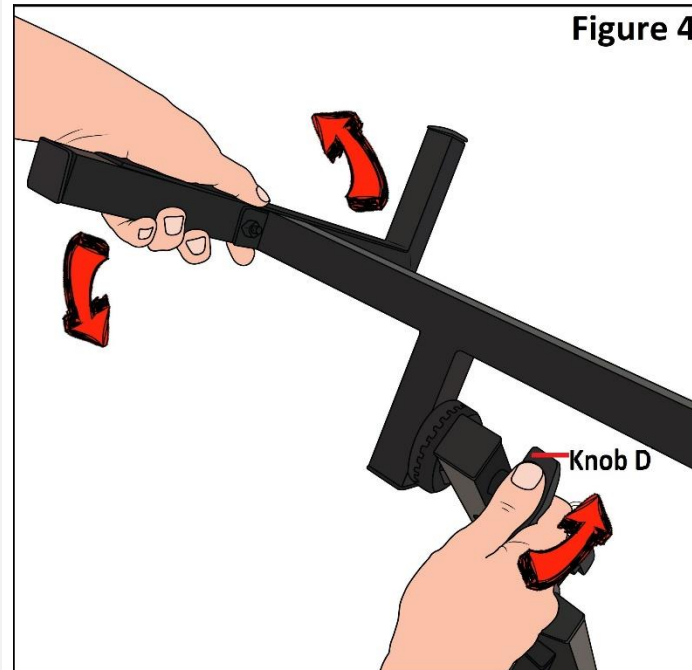

**Step 5** – For safety reasons, please always make sure to test the stability and safety of the product before use. Double check all nuts and bolts, knobs and connectors, make sure that these are tight and securely fastened before use of your product. Test the product under light use or light loads the first time to confirm assembly and structure of the product is correct

## ASSEMBLY AND DEMONSTRATION VIDEO

Please scan the QR Code below for the product demonstration video. Or go to the URL shown here and find the product video. [www.Griffin-Stands.com/Videos](http://www.Griffin-Stands.com/Videos)



Scan me