

PRODUCT SPECIFICATIONS

For current product specifications, please go to www.griffin-stands.com and type the model number into the search bar. Locate the product listing to view the current factory specifications.

TROUBLE SHOOTING

Performance Issue, Uneven or Unstable- Make sure all nuts and bolts are tight on the product. If they are, then loosen all nuts and bolts 1 full turn counter-clockwise, then go back and tighten each bolt only ½ turn tight. Then do a final tighten turn for another ½ turn tight. Next, Make sure there are not any missing nuts or bolts. Third, ensure all parts on the product are not broken or defective. Finally, Re-read the assembly instructions or watch the product demonstration video to ensure you have correctly assembled or are using the product properly with factory specifications.

Missing Parts- The pictures, videos and images shown in this manual might have changed style or count due to the product being redesigned. So in rare cases the part may no longer be included or of a different style. However, if you think you are missing a part that is necessary to the assembly and use of your product, then first carefully double check all packaging for any parts you think are missing. Some parts might be hiding in the packaging or loose in an inner box.

COMPANY INFORMATION AND SUPPORT

THANK YOU FOR YOUR PURCHASE

Thank you for purchasing the Griffin Rackmount Road Case. Your product comes with a 1 year factory warranty from purchase date. Please read all assembly instructions prior to assembling your new cart. Pictures that may aid in assembly can be found by going to www.griffin-stands.com and typing DEQ02 into the search bar.

Griffin™ stands and accessories are manufactured in several innovative factories responsible for developing products that address the newest needs and trends of the current market. We take pride in the Griffin™ brand and endeavor to be on the forefront of the musical stands and musical and lighting accessories market.



Griffin | 11408 Hwy 64 W, Tyler, TX 75704 |
info@griffin-stands.com | www.Griffin-Stands.com



User Manual Model# DEQ02



Rackmount Road Case

ASSEMBLY INSTRUCTIONS

Parts List

- | | |
|---------------------|---------------------------------|
| A. Base | F. Front Panel |
| B. Left Side Panel | G. Lid |
| C. Right Side Panel | H. Front Upper Horizontal Plate |
| D. Shelf | I. Back Horizontal Plate |
| E. Back Panel | |

Step 1 – As shown in

Figure 1, take the base (Part A) and Right Side Panel (Part C). Connect the panel on the side of the base perpendicularly and screw down (See **Figure 2**) Do the same thing by taking the Left side Panel (Part B) and connecting over to the other side.

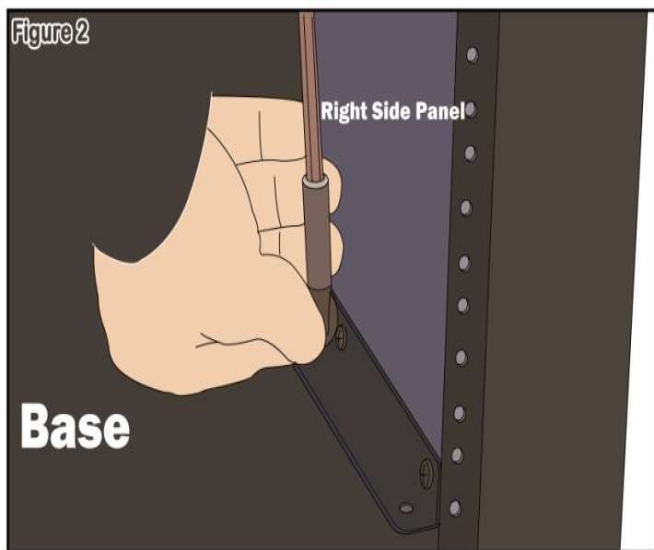
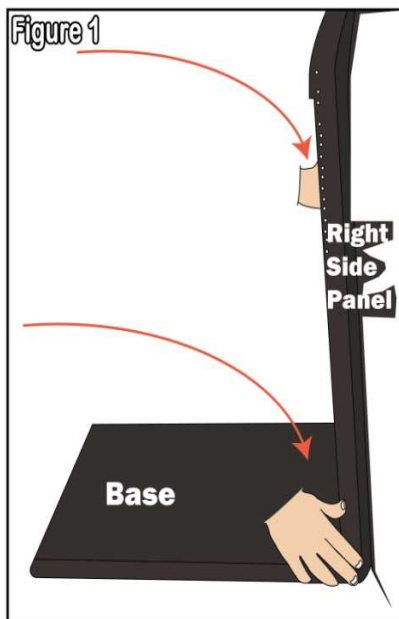

Parts List

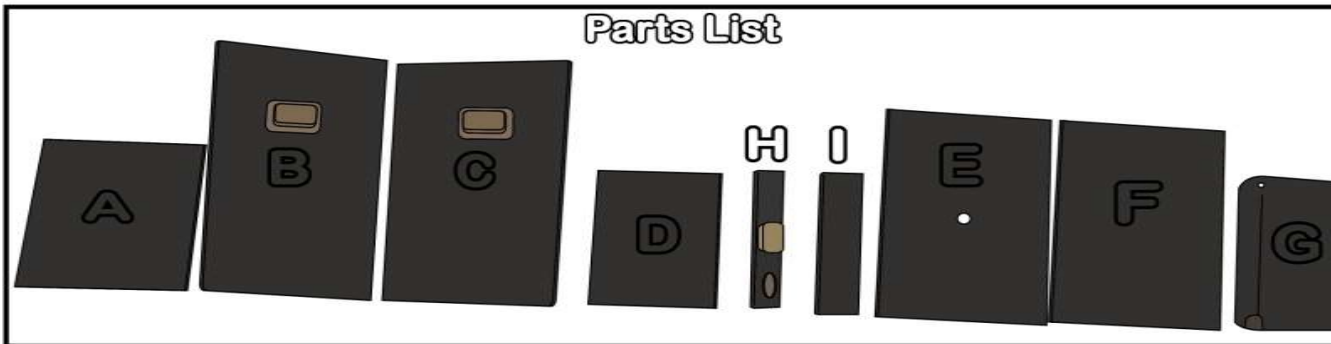

Step 2 – Take Back Horizontal Plate (Part I) and place it on the top of the assembly done in Step 1 and screw together (See **Figure 3** and **4**)

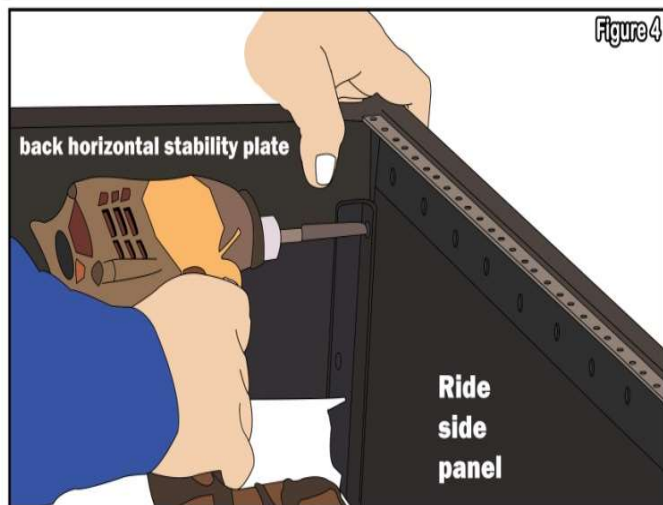
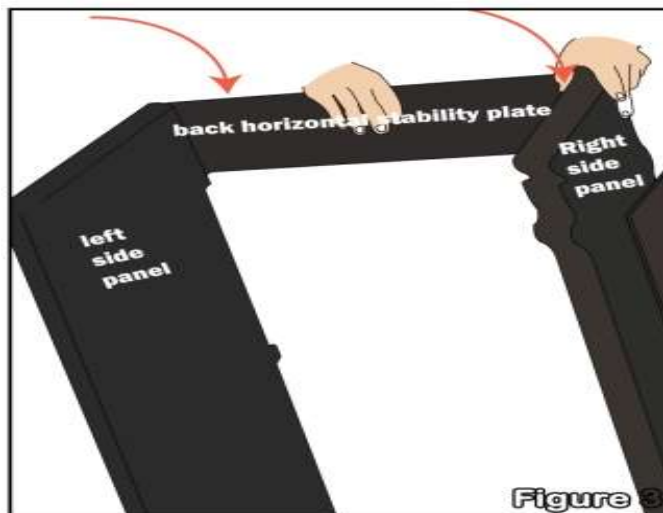

Step 3 – Now, take Front Upper Horizontal Plate (Part H) and connect in front of the stand screw in together on the corners (See **Figure 5** and **6**)

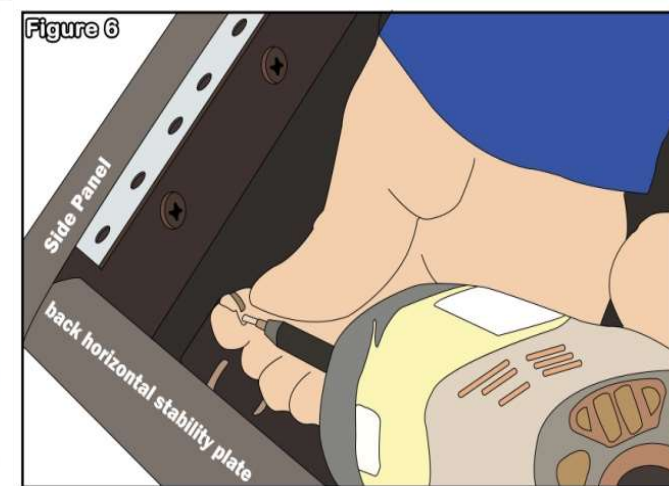
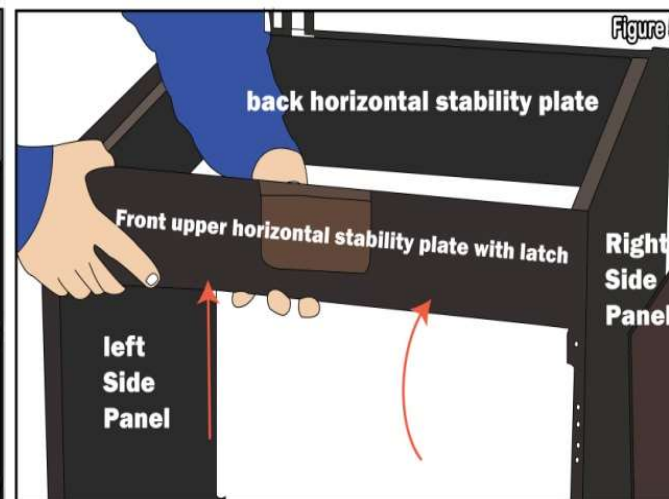

ASSEMBLY INSTRUCTIONS

Step 4 – Get the lid (Part G) and place on top. Behind the lid (Part G) are the hinges that is attached to Back Horizontal Plate (Part I) using a screw as shown in [Figure 7](#). Now in between Back Horizontal Plate (Part I) and the side panels screw in the L-Brackets for a more secure back horizontal plate. (See [Figure 8](#)). Attach the four “L” brackets. The front “L” brackets should be attached 1” (2.5cm) from the top. The back “L” brackets should be attached 2” (5cm) from the top.

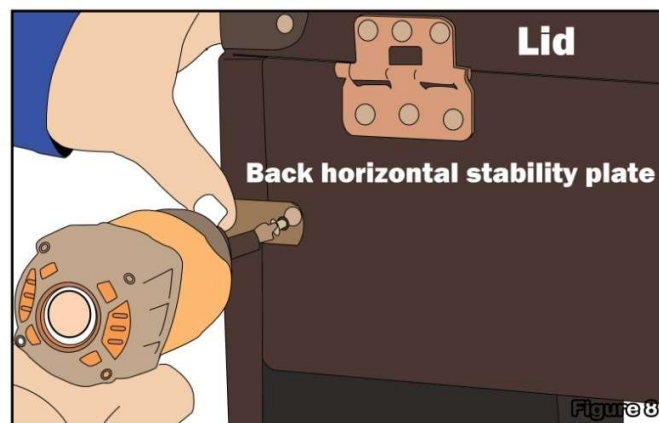
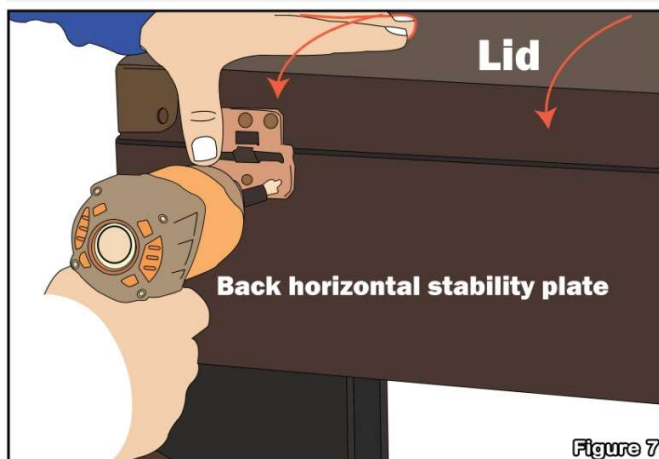

Step 5 – Turn the stand to the side, at the base (Part A) measure and divide to three sections. Measuring from the front, the leading edge of the bracket closest to the front should be 6” (15.2cm) and the leading edge of the bracket closest to the back should be 13” (33cm). This is where you will drill and screw in the L-Brackets. Do the same step on the other side as seen on [Figure 9](#). Also, while the stand laying on one side you can install the chrome corner brackets as shown in [Figure 10](#).

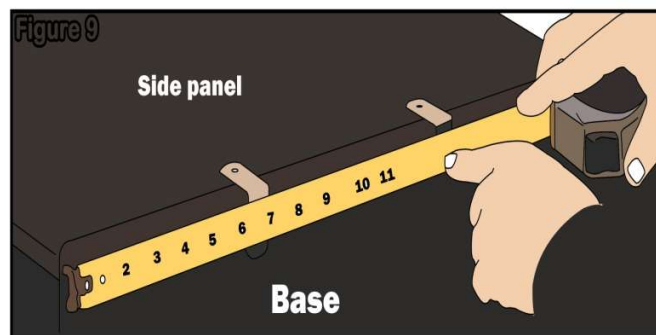

Step 6 – [Figure 11](#) shows how to place the wheels. Place the metal plate inside (opposite side of the caster wheels) and align the wheels outside. There should be a pre-drilled hole that will guide you to secure the wheels with bolts, nuts and washers.

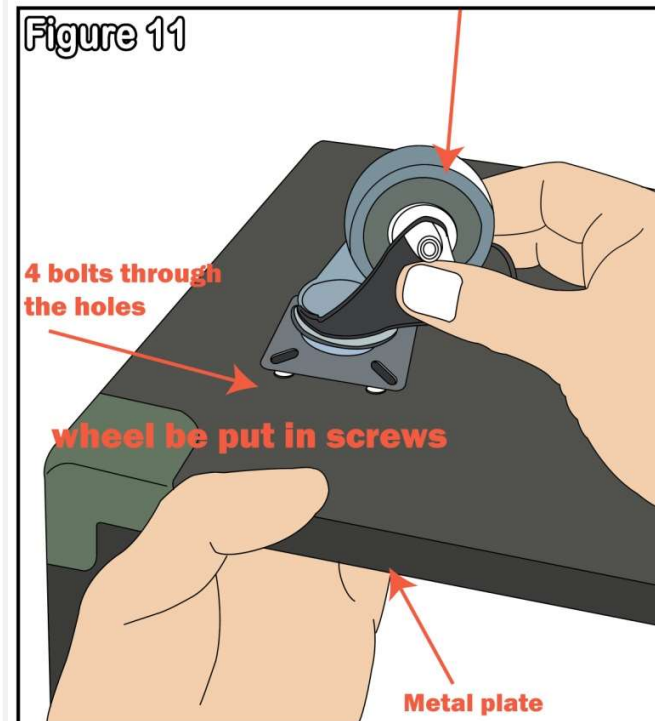

Step 7 – Place the middle shelf (Part D) inside. There is a support tab inside the stand where the shelf rests. (Refer to [Figure 12](#))

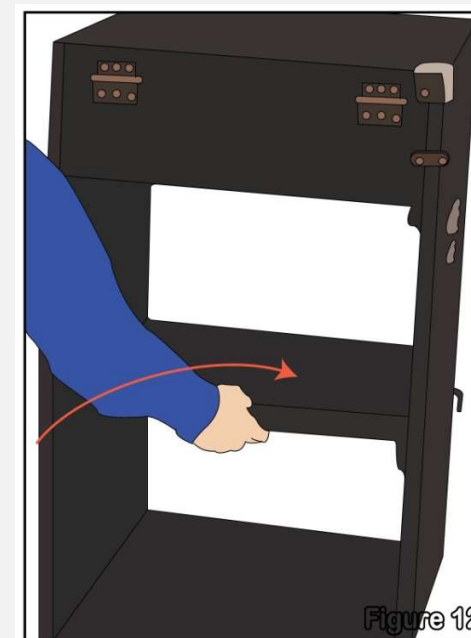

ASSEMBLY INSTRUCTIONS

Step 8 – Now take Back Panel (Part E) and place it on the back of the stand. This is secured by a Velcro (See **Figure 13**). And do the same thing for Front Panel (Part F). For the Front Panel (Part F), make sure that the ribbon is flipped outside so that removing the front panel is easy.

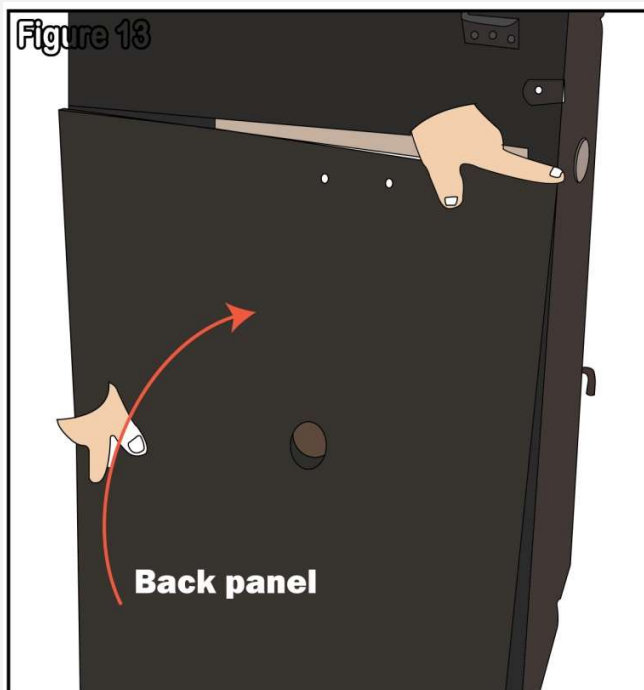

Step 9 – **Figure 14** shows how to lock and unlock the top lid. The top lid can be removed if you tilt it all the way to the back. It can be removed from the hinges by design.

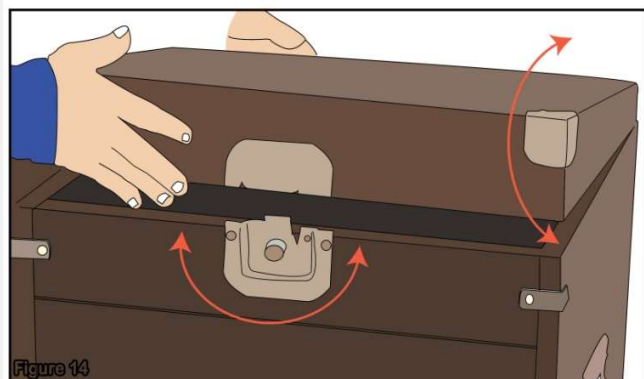

Step 10 - For safety reasons, please always make sure to test the stability and safety of the product before use. Double check all nuts and bolts, knobs and connectors, make sure that these are tight and securely fastened before use of your product. Test the product under light use or light loads the first time to confirm assembly and structure of the product is correct.

Please note that if your mixer is smaller than the minimum capacity of the top shelf, you will need a wider rack ears to be able to mount your mixer. Place heavy equipment at the bottom and lighter equipment at the top. See **Figure 15** for how a mixer should look like installed.

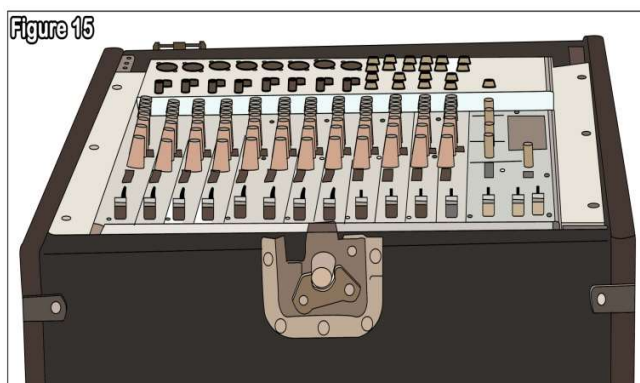

Your rack case has many great features. Let's talk about a couple. To use the locking latch, simply turn the knob on the bottom half of the latch counter clockwise until the latch is fully extended. Then push the latch forward until the latch goes into the slot on the upper half of the latch found on the lid. Then turn the knob clockwise to hold it in place. It even comes with a place you can put a lock on your case. The front panel and back panel can be removed for easy access to your equipment. The back panel even has a hole for running your cables through for a nicer and neater looking setup.

Two of your casters have locking wheels. To use the locks, simply push down on the “brake” that sticks out from the wheel. To release the “brake” just pull up on it. This is a great feature that you’ll be using often. Your DEQ-02 comes with pre-installed rack mount brackets and the screws to install your equipment. Use the included screws to attach the “wings” of your rack mount equipment to the rack rails. The top will hold a “flat” or “slider” sound board.

ASSEMBLY AND DEMONSTRATION VIDEO

Please scan the QR Code below for the product demonstration video. Or go to the URL shown here and find the product video. www.Griffin-Stands.com/Videos

