

PRODUCT SPECIFICATIONS

For current product specifications, please go to www.griffin-stands.com and type the model number into the search bar. Locate the product listing to view the current factory specifications.

TROUBLE SHOOTING

Performance Issue, Uneven or Unstable- Make sure all nuts and bolts are tight on the product. If they are, then loosen all nuts and bolts 1 full turn counter-clockwise, then go back and tighten each bolt only $\frac{1}{2}$ turn tight. Then do a final tighten turn for another $\frac{1}{2}$ turn tight. Next, Make sure there are not any missing nuts or bolts. Third, ensure all parts on the product are not broken or defective. Finally, Re-read the assembly instructions or watch the product demonstration video to ensure you have correctly assembled or are using the product properly with factory specifications.

Missing Parts- The pictures, videos and images shown in this manual might have changed style or count due to the product being redesigned. So in rare cases the part may no longer be included or of a different style. However, if you think you are missing a part that is necessary to the assembly and use of your product, then first carefully double check all packaging for any parts you think are missing. Some parts might be hiding in the packaging or loose in an inner box.

COMPANY INFORMATION AND SUPPORT

THANK YOU FOR YOUR PURCHASE

Thank you for purchasing the Griffin Lighting Truss Stand System. Your product comes with a 1 year factory warranty from purchase date. Please read all assembly instructions prior to assembling your new cart. Pictures that may aid in assembly can be found by going to www.griffin-stands.com and typing AP3101 into the search bar.

Griffin™ stands and accessories are manufactured in several innovative factories responsible for developing products that address the newest needs and trends of the current market. We take pride in the Griffin™ brand and endeavor to be on the forefront of the musical stands and musical and lighting accessories market.



Griffin | 11408 Hwy 64 W, Tyler, TX 75704 |
info@griffin-stands.com | www.Griffin-Stands.com



User Manual Model# AP3101



Lighting Truss Stand System

ASSEMBLY INSTRUCTIONS

Parts List

- A. T-Bars – 2pcs
- B. Slide Mount “T” collars/connectors including the 2 on the T-bars – 10pcs
- C. Center “I-Beam” Support Bars – 2pcs
- D. Beam Connectors (with holes along the side) – 4pcs
- E. “I-Beam” Truss Sections – 3pcs
- F. Tripod Stands – 2pcs

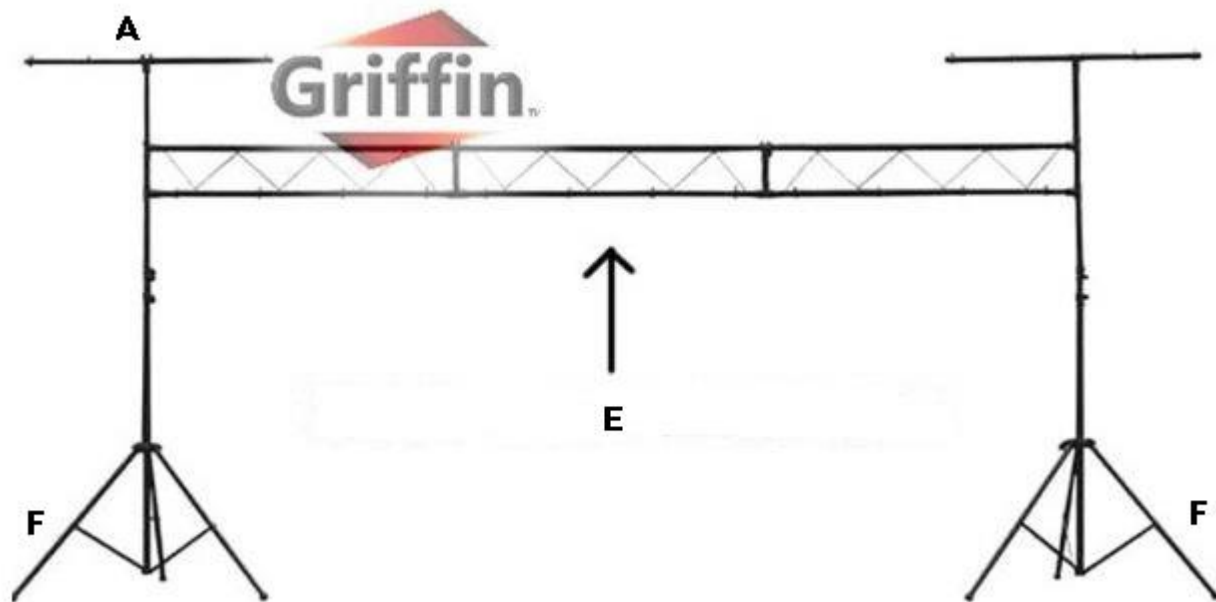
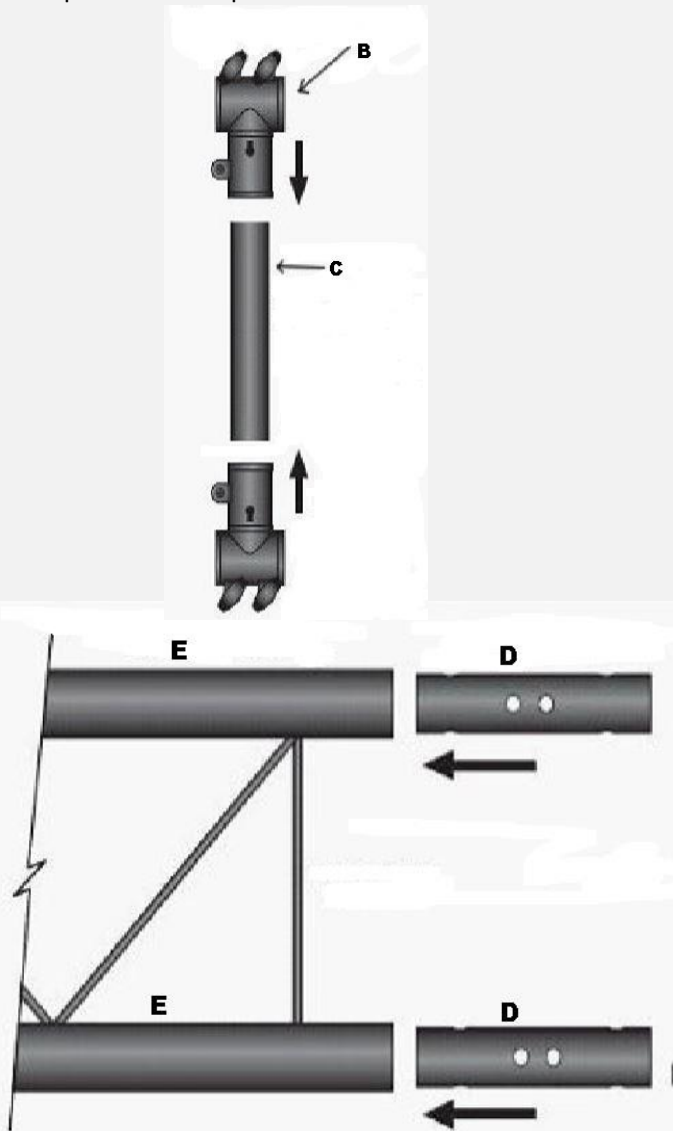

Step 1 – As shown in **Figure 1**, turn the stand (Part F) upside down to have more leverage in spreading the legs. Spread the legs wide for a more secure stand and tighten the knob.

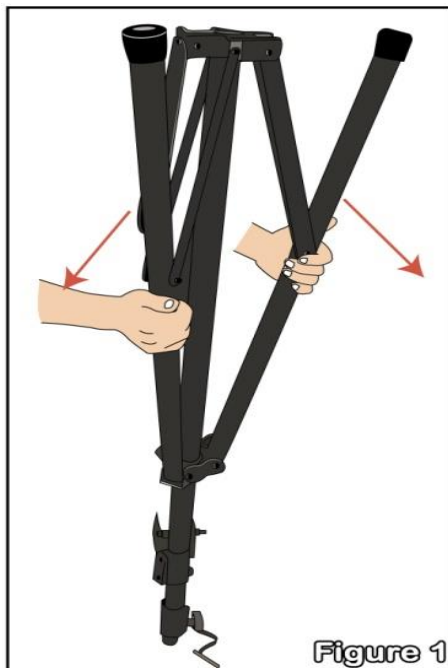

Step 2 – **Figure 2** is about the top the tripod stand, which is already inserted and can be adjusted by the use of the knob. Loosen the knob to adjust the height and tighten to secure as shown in **Figure 3**.

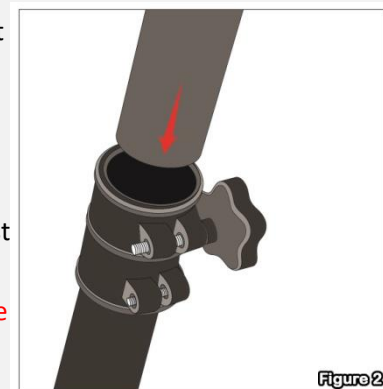

Figure 2

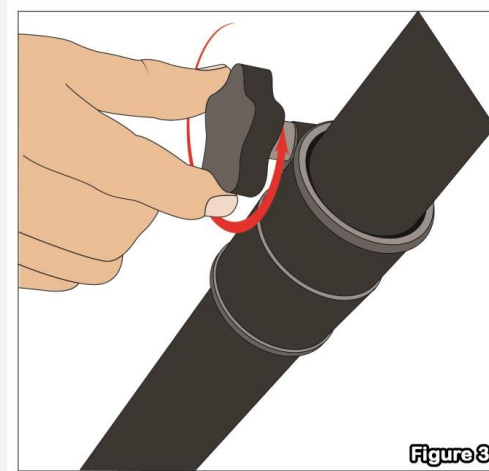

Figure 3

ASSEMBLY INSTRUCTIONS

Step 3 – Take Slide Mount “T” collars (Part B) and slide 2pcs on each stand. Tighten the knobs to secure in place, make sure that the T-connectors on one stand is facing the same direction. The direction of where the trusses will join together, and the distance is the same see [Figure 4](#).

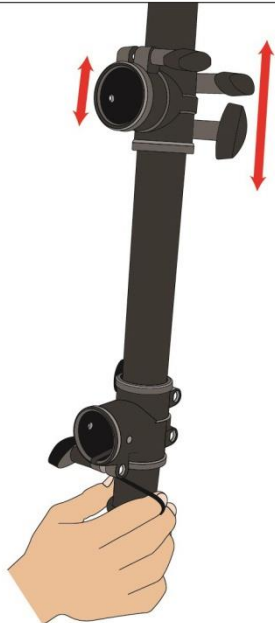

Figure 4

Step 4 – Take the 1 pc of “I-Beam” Truss Sections (Part E) and insert 1pc of Beam Connectors (Part D) to each end this part will be the center I-Beam of the truss section, secure these using a bolt, washer and nut. Make sure the holes in the Beam Connectors (Part D) are lined up with the holes in “I-Beam” Truss Sections (Part E) to insert the bolts. (See [Figure 5](#), [6](#) and [7](#))

Figure 5

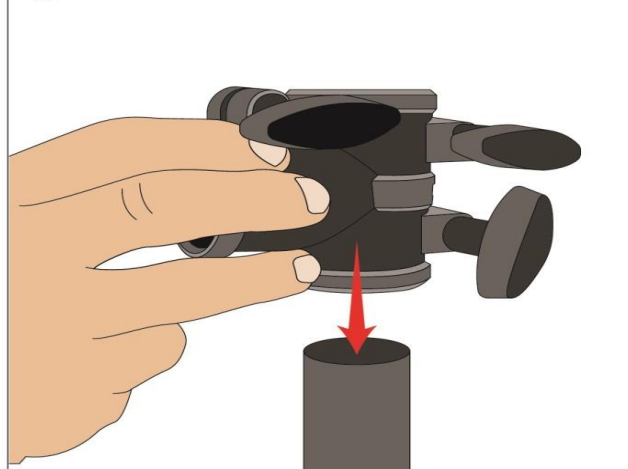

Figure 6

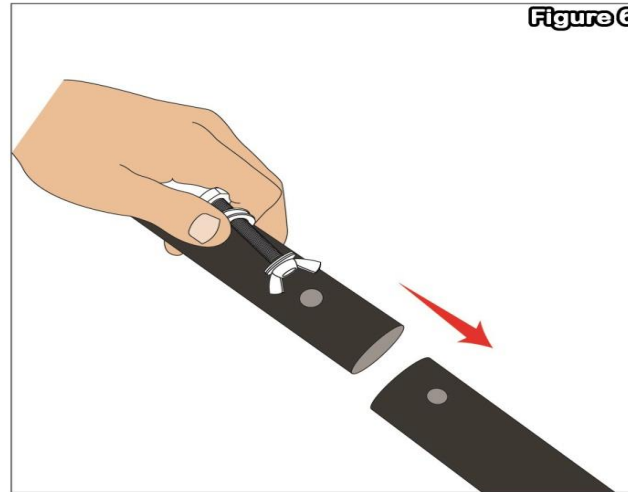
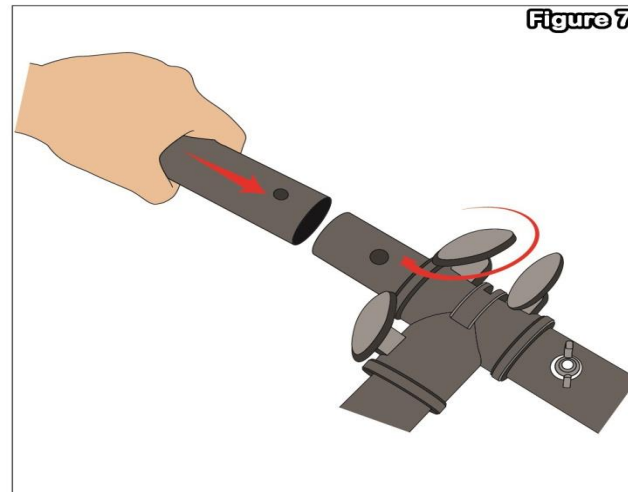

Figure 7



Step 5 – Take the assembly done in Step 4 and slide each end to the top of the tripod stand and tighten the knob as shown in [Figure 8](#). Secure by tightening the knob and sliding the locking pins through the holes, refer to [Figure 9](#).

Figure 8

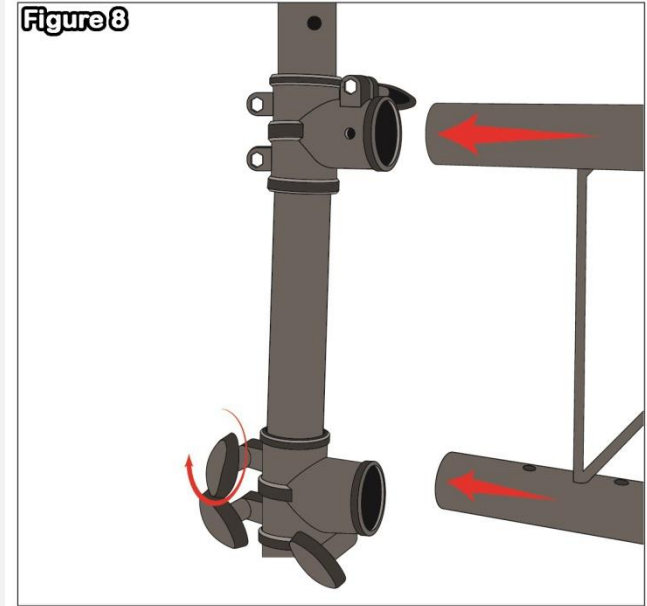
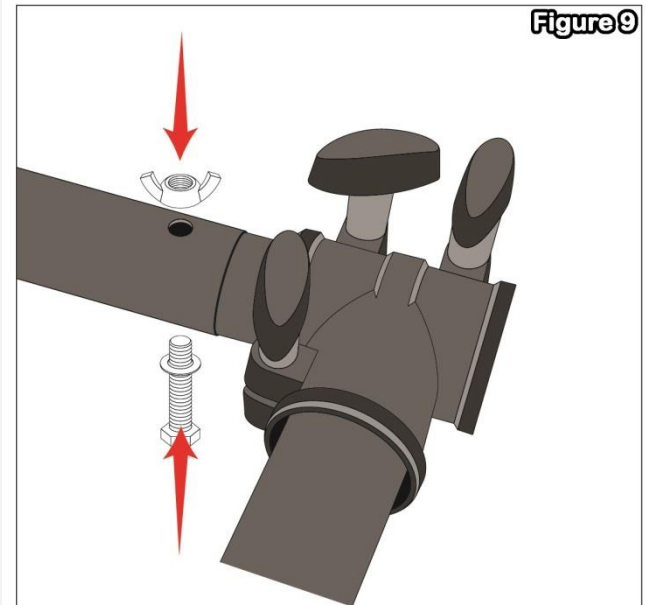
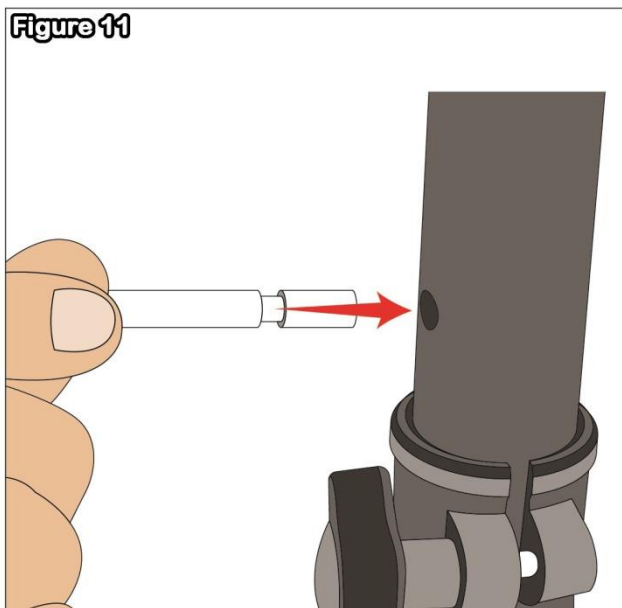

Figure 9



ASSEMBLY INSTRUCTIONS

Step 6 – Loosen the knob shown in **Figure 10** and slide the inner pipe through the T-connectors. Tighten to secure the height, use the locking pin at the top most part to further secure the height of the stand. This will also help the stand bear weight as the light fixtures and other equipment are mounted (See **Figure 11**)



Step 6 – **Figure 12** shows how to insert the T-bars (Part A) at the top of the stand. Just slide the remaining T-connectors (Part B) at the top of the tripod stands and tighten the knob.

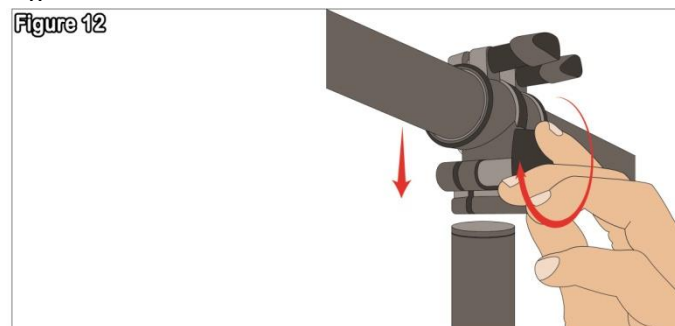

Step 7 – As shown in **Figure 13** how to mount light fixtures and other equipment to the T-bar (Part A) and the I-beam (Part E).

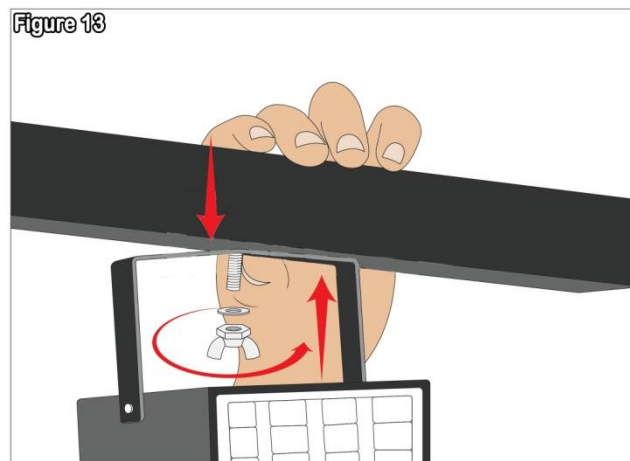

Step 8 – To raise the truss, loosen the top height adjustment rod on both tripods. (This is the knob located closest to the top of the tripod assembly.) Raise both sides evenly to the desired height, insert the safety pin and tighten the knobs. Using this height adjustment you can raise the truss about 1 ½ feet. There is a second height adjustment point located directly below this one if you desire additional height. IF USING THE FULL FIFTEEN FOOT SPAN THIS WILL REQUIRE TWO PEOPLE. FAILURE TO USE THE SAFETY PINS AND TIGHTEN THE KNOBS COULD CAUSE TRUSS FAILURE CAUSING INJURY TO YOURSELF AND/OR OTHERS.

Step 9 – For safety reasons, please always make sure to test the stability and safety of the product before use. Double check all nuts and bolts, knobs and connectors, make sure that these are tight and securely fastened before use of your product. Test the product under light use or light loads the first time to confirm assembly and structure of the product is correct.

For safety reasons, please always make sure to test the stability and safety of the product before use. Double check all nuts and bolts, knobs and connectors, make sure that these are tight and securely fastened before mounting items. As a general rule the higher the height of the system, the less stable the stand will be and less weight can be mounted. Additionally, spread the legs wider for a more secure and balanced stand especially if the stand will be carrying heavy items. The wider the legs are the more stable the stand will be. Also, make sure that the weight is evenly distributed throughout the stand system. Heavier equipment loads need to be installed near the tripod stand, while lighter ones can be mounted on the middle truss or further away from the tripod stand. If your system is a 3-truss section setup, then always keep the weight load of the middle truss limited to only 50% of the weight that is on connecting trusses. This would mean your middle truss will only be ½ of the weight on it as the connecting trusses. After you have mounted your equipment, always check the stability of the weight load.

ASSEMBLY AND DEMONSTRATION VIDEO

Please scan the QR Code below for the product demonstration video. Or go to the URL shown here and find the product video. www.Griffin-Stands.com/Videos



Scan me